

**K7010 Schnellkupplung mit Schlauchdüse,**  
90° Ausführung, mit Ventil oder freiem Durchgang

**Quick release coupling with hose nipple,**  
90° design, with and without valve

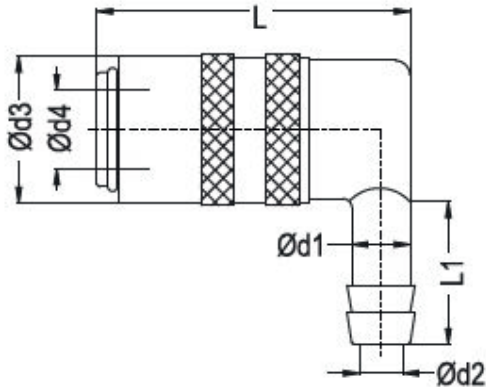

Material: **Standardversion / Standard version**

Kupplungsgrundkörper: Messing / Coupler Body: Brass  
Hülse: Messing / Sleeve: Brass  
Ventil: Messing / Valve: Brass  
Feder: Edelstahl / Spring: Stainless Steel  
Sprengling: Edelstahl / Locking O-Ring: Stainless Steel  
Kugeln: Edelstahl V-/ Balls: Stainless Steel



Betriebsdruck / Working pressure: p (bar)

Optionen / Options:

Verchromt / Chrome plated – Index: -Cr  
Vernickelt / Nickel plated – Index: -Ni  
Edelstahl / Stainless Steel – Index: -S

P= Stück / Normpackung // Pieces/ standard pack

Bei optionaler Bestellung bitte Kennbuchstaben hinzufügen:  
For optional orders please add the options index end of the order no.:  
( Beispiel/example: K7010-d1-d4-V-Cr)

p (bar)	d2 (mm)	d3 (mm)	L (mm)	L1 (mm)	P	d1 (mm)	d4 (mm)	 <b>Bestellnummer Order Number Mit Ventil / with Valve</b>	 <b>Bestellnummer Order Number ohne Ventil / without Valve</b>
0 - 10	2,7	10	29,5	13,5	10	5	5	K7010-05-05-V	K7010-05-05
	4,5	17	41	17,0		6	9	K7010-06-09-V	K7010-06-09
	6					8		K7010-08-09-V	K7010-08-09
						9		K7010-09-09-V	K7010-09-09
						10		K7010-13-09-V	K7010-13-09
0 - 15	8	23	51	23		10	13	K7010-10-13-V	K7010-10-13
	9					13		K7010-13-13-V	K7010-13-13
0 - 20	13	31	78	32		19	19	K7010-19-19-V	K7010-19-19

**Dauertemperatur / Long-term service temperature**

K7010	Standard	
	Medium	Max. C°
	Öl / Oil	160
	Wasser / Water	120

K7011	Hochtemperatur High temperature	
	Medium	Max. C°
	Öl / Oil	200
	Wasser / Water	160

K7012	Höchsttemperatur High of temperature	
	Medium	Max. C°
	Öl / Oil	300
	Wasser / Water	250