

**K7015 Schnellkupplung mit Schlauchtülle, "Push-to-Lock"**  
gerade Ausführung, mit Ventil oder freiem Durchgang

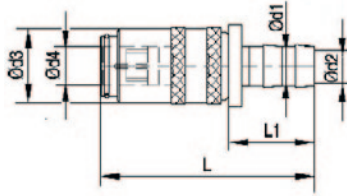

**Wölfel-Industriebedarf**  
Industrievertretungen

**Quick release coupling with hose nipple, "Push-to-Lock"**  
straight design, with and without valve



Material: **Standardversion / Standard version**

Kupplungsgrundkörper: Messing / Coupler Body: Brass

Hülse: Messing / Sleeve: Brass

Ventil: Messing / Valve: Brass

Feder: Edelstahl / Spring: Stainless Steel

Sprengring: Edelstahl / Locking O-Ring: Stainless Steel

Kugeln: Edelstahl V-/ Balls: Stainless Steel

Betriebsdruck / Working pressure: p (bar)

Optionen / Options:



Verchromt / Chrome plated – Index: -Cr

Vernickelt / Nickel plated – Index: -Ni

Edelstahl / Stainless Steel – Index: -S

P= Stück / Normpackung // Pieces/ standard pack

Bei optionaler Bestellung bitte Kennbuchstaben hinzufügen:  
For optional orders please add the options index end of the order no.:  
( Beispiel/example: K7010-d1-d4-V-Cr)

p (bar)	d2 (mm)	d3 (mm)	L (mm)	L1 (mm)	P	d1 (mm)	d4 (mm)	 Bestellnummer Order Number Mit Ventil / with Valve	 Bestellnummer Order Number ohne Ventil / without Valve
0 - 15	7,5	17	54	24	10	10	9	K7015-10-09-V	K7015-10-09
0 - 10	10	23	64	28		13	13	K7015-13-13-V	K7015-13-13

**Dauertemperatur / Long-term service temperature**

K7015	Standard	
	Medium	Max. C°
	Öl / Oil	160
	Wasser / Water	120

K7016	Hochtemperatur High temperature	
	Medium	Max. C°
	Öl / Oil	200
	Wasser / Water	160

K7017	Höchsttemperatur High of temperature	
	Medium	Max. C°
	Öl / Oil	300
	Wasser / Water	250