

**K7165 Doppelnippel,
mit freiem Durchgang**

**Double side connector,
without valve**

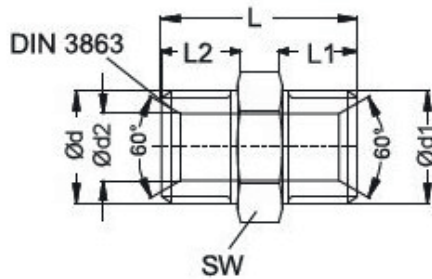

Material: **Standardversion / Standard version**

Grundkörper: Messing / Body: Brass

Temp: -20 °C-+200 °C (-40 °F - +390 °F)

Betriebsdruck / Working pressure: p (bar)

Optionen / Options:

Verchromt / Chrome plated – Index: -Cr

Vernickelt / Nickel plated – Index: -Ni

Edelstahl / Stainless Steel – Index: -S

P= Stück / Normpackung // Pieces/ standard pack

Bei optionaler Bestellung bitte Kennbuchstaben hinzufügen:
For optional orders please add the options index end of the order no.:
(Beispiel/example: K7165-d1-d-Cr)

p (bar)	d2 (mm)	L (mm)	L1 (mm)	L2 (mm)	SW (mm)	P	d (mm)	d1 (mm)	 Bestellnummer Order Number ohne Ventil / without Valve	
0-20	6	24	9	9	17	10	M14x1,5	M14x1,5	K7165 - M14x1,5 - M14x1,5	
					15		BSP 1/4	K7165 - M14x1,5 - BSP 1/4		
	9	24	9	9	17	10	BSP 1/4	BSP 1/4	K7165 - BSP 1/4 - BSP 1/4	
					19		M16x1,5	M16x1,5	K7165 - M16x1,5 - M16x1,5	
13	40	40	16	16	27	10	BSP 3/8	BSP 3/8	K7165 - M16x1,5 - BSP 3/8	
					25		BSP 3/8	BSP 3/8	K7165 - BSP 3/8 - BSP 3/8	
	36	40	16	16	16	10	M24x1,5	M24x1,5	K7165- M24x1,5 - M24x1,5	
							22	BSP 1/2	BSP 1/2	K7165- M24x1,5 – BSP 1/2
							27	BSP 1/2	BSP 1/2	K7165- BSP 1/2 – BSP 1/2
40	40	40	16	16	10	BSP 3/4	BSP 3/4	K7165- BSP 3/4 - BSP 3/4		