

K7000 Schnellkupplung mit Schlauchtülle,
gerade Ausführung, mit Ventil oder freiem Durchgang

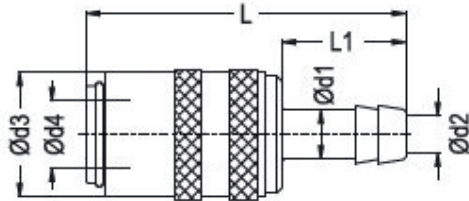

Wölfel-Industriebedarf
Industriervertretungen

Quick release coupling with hose nipple,
straight design, with and without valve



P= Stück / Normpackung // Pieces/ standard pack

Material: **Standardversion / Standard version**



Kupplungsgrundkörper: Messing / Coupler Body: Brass
Hülse: Messing / Sleeve: Brass
Ventil: Messing / Valve: Brass
Feder: Edelstahl / Spring: Stainless Steel
Sprengling: Edelstahl / Locking O-Ring: Stainless Steel
Kugeln: Edelstahl V-/ Balls: Stainless Steel

Betriebsdruck / Working pressure: p (bar)

Optionen / Options:

Verchromt / Chrome plated – Index: -Cr
Vernickelt / Nickel plated – Index: -Ni
Edelstahl / Stainless Steel – Index: -S

Bei optionaler Bestellung bitte Kennbuchstaben hinzufügen:
For optional orders please add the options index end of the order no.:
(Beispiel/example: K7000-d1-d4-V-Cr)

p (bar)	d2 (mm)	d3 (mm)	L (mm)	L1 (mm)	P	d1 (mm)	d4 (mm)	 Bestellnummer Order Number Mit Ventil / with Valve	 Bestellnummer Order Number ohne Ventil / without Valve
0 - 10	2,7	10	35	13,5	10	5	5	K7000-05-05-V	K7000-05-05
	4,5	17	46	17,0		6	9	K7000-06-09-V	K7000-06-09
	6					8		K7000-08-09-V	K7000-08-09
						9		K7000-09-09-V	K7000-09-09
						10		K7000-10-09-V	K7000-10-09
				52		23	13		K7000-13-09-V
0 - 15	8	23	60			10	13	K7000-10-13-V	K7000-10-13
	10					13		K7000-13-13-V	K7000-13-13
0 - 20	13	31	90	32		19	19	K7000-19-19-V	K7000-19-19

Dauertemperatur / Long-term service temperature

K7000	Standard	
	Medium	Max. C°
	Öl / Oil	160
	Wasser / Water	120

K7001	Hochtemperatur High temperature	
	Medium	Max. C°
	Öl / Oil	200
	Wasser / Water	160

K7002	Höchsttemperatur High of temperature	
	Medium	Max. C°
	Öl / Oil	300
	Wasser / Water	250

K7005 Schnellkupplung mit Schlauchdüse,
45° Ausführung, mit Ventil oder freiem Durchgang

Quick release coupling with hose nipple,
45° design, with and without valve

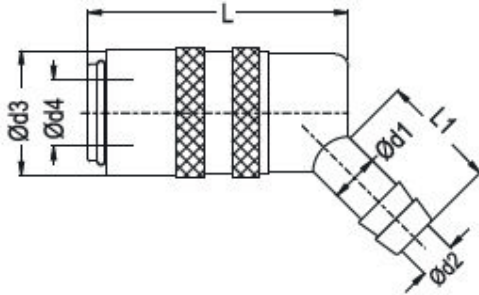

Material: **Standardversion / Standard version**

Kupplungsgrundkörper: Messing / Coupler Body: Brass
Hülse: Messing / Sleeve: Brass
Ventil: Messing / Valve: Brass
Feder: Edelstahl / Spring: Stainless Steel
Sprengring: Edelstahl / Locking O-Ring: Stainless Steel
Kugeln: Edelstahl V-/ Balls: Stainless Steel



Betriebsdruck / Working pressure: p (bar)

Optionen / Options:

Verchromt / Chrome plated – Index: -Cr
Vernickelt / Nickel plated – Index: -Ni
Edelstahl / Stainless Steel – Index: -S

P= Stück / Normpackung // Pieces/ standard pack

Bei optionaler Bestellung bitte Kennbuchstaben hinzufügen:
For optional orders please add the options index end of the order no.:
(Beispiel/example: K7005-d1-d4-V-Cr)

p (bar)	d2 (mm)	d3 (mm)	L (mm)	L1 (mm)	P	d1 (mm)	d4 (mm)	 Bestellnummer Order Number Mit Ventil / with Valve	 Bestellnummer Order Number ohne Ventil / without Valve
0 - 10	2,7	10	29,5	13,5	10	5	5	K7005-05-05-V	K7005-05-05
	4,5	17	41	17,0		6	9	K7005-06-09-V	K7005-06-09
	6					8		K7005-08-09-V	K7005-08-09
						9		K7005-09-09-V	K7005-09-09
						10		K7005-13-09-V	K7005-13-09
0 - 15	8	23	51	23		10	13	K7005-10-13-V	K7005-10-13
	9					13		K7005-13-13-V	K7005-13-13
0 - 20	13	31	78	32		19	19	K7005-19-19-V	K7005-19-19

Dauertemperatur / Long-term service temperature

K7005	Standard	
	Medium	Max. C°
	Öl / Oil	160
	Wasser / Water	120

K7006	Hochtemperatur High temperature	
	Medium	Max. C°
	Öl / Oil	200
	Wasser / Water	160

K7007	Höchsttemperatur High of temperature	
	Medium	Max. C°
	Öl / Oil	300
	Wasser / Water	250

K7010 Schnellkupplung mit Schlauchdüse,
90° Ausführung, mit Ventil oder freiem Durchgang

Quick release coupling with hose nipple,
90° design, with and without valve

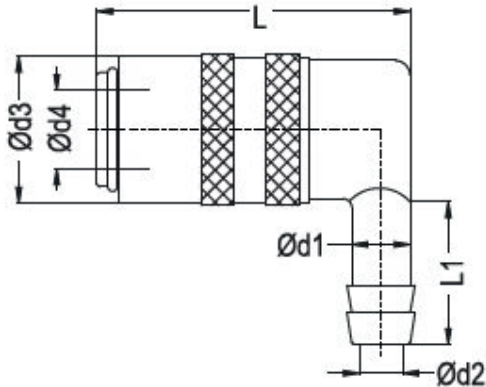

Material: **Standardversion / Standard version**

Kupplungsgrundkörper: Messing / Coupler Body: Brass
Hülse: Messing / Sleeve: Brass
Ventil: Messing / Valve: Brass
Feder: Edelstahl / Spring: Stainless Steel
Sprengling: Edelstahl / Locking O-Ring: Stainless Steel
Kugeln: Edelstahl V-/ Balls: Stainless Steel



Betriebsdruck / Working pressure: p (bar)

Optionen / Options:

Verchromt / Chrome plated – Index: -Cr
Vernickelt / Nickel plated – Index: -Ni
Edelstahl / Stainless Steel – Index: -S

P= Stück / Normpackung // Pieces/ standard pack

Bei optionaler Bestellung bitte Kennbuchstaben hinzufügen:
For optional orders please add the options index end of the order no.:
(Beispiel/example: K7010-d1-d4-V-Cr)

p (bar)	d2 (mm)	d3 (mm)	L (mm)	L1 (mm)	P	d1 (mm)	d4 (mm)	 Bestellnummer Order Number Mit Ventil / with Valve	 Bestellnummer Order Number ohne Ventil / without Valve
0 - 10	2,7	10	29,5	13,5	10	5	5	K7010-05-05-V	K7010-05-05
	4,5	17	41	17,0		6	9	K7010-06-09-V	K7010-06-09
	6					8		K7010-08-09-V	K7010-08-09
						9		K7010-09-09-V	K7010-09-09
						10		K7010-13-09-V	K7010-13-09
0 - 15	8	23	51	23		10	13	K7010-10-13-V	K7010-10-13
	9					13		K7010-13-13-V	K7010-13-13
0 - 20	13	31	78	32		19	19	K7010-19-19-V	K7010-19-19

Dauertemperatur / Long-term service temperature

K7010	Standard	
	Medium	Max. C°
	Öl / Oil	160
	Wasser / Water	120

K7011	Hochtemperatur High temperature	
	Medium	Max. C°
	Öl / Oil	200
	Wasser / Water	160

K7012	Höchsttemperatur High of temperature	
	Medium	Max. C°
	Öl / Oil	300
	Wasser / Water	250

K7015 Schnellkupplung mit Schlauchtülle, "Push-to-Lock"
gerade Ausführung, mit Ventil oder freiem Durchgang



Wölfel-Industriebedarf
Industrievertretungen

Quick release coupling with hose nipple, "Push-to-Lock"
straight design, with and without valve

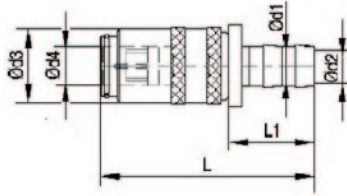

Material: **Standardversion / Standard version**

Kupplungsgrundkörper: Messing / Coupler Body: Brass

Hülse: Messing / Sleeve: Brass

Ventil: Messing / Valve: Brass

Feder: Edelstahl / Spring: Stainless Steel

Sprengtring: Edelstahl / Locking O-Ring: Stainless Steel

Kugeln: Edelstahl V-/ Balls: Stainless Steel

Betriebsdruck / Working pressure: p (bar)

Optionen / Options:

Verchromt / Chrome plated – Index: -Cr

Vernickelt / Nickel plated – Index: -Ni

Edelstahl / Stainless Steel – Index: -S

P= Stück / Normpackung // Pieces/ standard pack

Bei optionaler Bestellung bitte Kennbuchstaben hinzufügen:
For optional orders please add the options index end of the order no.:
(Beispiel/example: K7010-d1-d4-V-Cr)

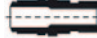
p (bar)	d2 (mm)	d3 (mm)	L (mm)	L1 (mm)	P	d1 (mm)	d4 (mm)	 Bestellnummer Order Number Mit Ventil / with Valve	 Bestellnummer Order Number ohne Ventil / without Valve
0 - 15	7,5	17	54	24	10	10	9	K7015-10-09-V	K7015-10-09
0 - 10	10	23	64	28		13	13	K7015-13-13-V	K7015-13-13

Dauertemperatur / Long-term service temperature

K7015	Standard	
	Medium	Max. C°
	Öl / Oil	160
	Wasser / Water	120

K7016	Hochtemperatur High temperature	
	Medium	Max. C°
	Öl / Oil	200
	Wasser / Water	160

K7017	Höchsttemperatur High of temperature	
	Medium	Max. C°
	Öl / Oil	300
	Wasser / Water	250

K7020 Schnellkupplung mit Schlauchtülle, "Push-to-Lock"
90° Ausführung, mit Ventil oder freiem Durchgang



Wölfel-Industriebedarf
Industrievertretungen

Quick release coupling with hose nipple, "Push-to-Lock"
90° design, with and without valve

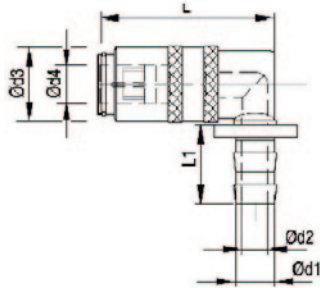

Material: **Standardversion / Standard version**

Kupplungsgrundkörper: Messing / Coupler Body: Brass
Hülse: Messing / Sleeve: Brass
Ventil: Messing / Valve: Brass
Feder: Edelstahl / Spring: Stainless Steel
Sprengring: Edelstahl / Locking O-Ring: Stainless Steel
Kugeln: Edelstahl V-/ Balls: Stainless Steel



Betriebsdruck / Working pressure: p (bar)

Optionen / Options:

Verchromt / Chrome plated – Index: -Cr
Vernickelt / Nickel plated – Index: -Ni
Edelstahl / Stainless Steel – Index: -S

P= Stück / Normpackung // Pieces/ standard pack

Bei optionaler Bestellung bitte Kennbuchstaben hinzufügen:
For optional orders please add the options index end of the order no.:
(Beispiel/example: K7010-d1-d4-V-Cr)

p (bar)	d2 (mm)	d3 (mm)	L (mm)	L1 (mm)	P	d1 (mm)	d4 (mm)	 Bestellnummer Order Number Mit Ventil / with Valve	 Bestellnummer Order Number ohne Ventil / without Valve
0 - 15	7,5	17	42	24	10	10	9	K7020-10-09-V	K7020-10-09
0 - 10	10	23	52	28		13	13	K7020-13-13-V	K7020-13-13

Dauertemperatur / Long-term service temperature

K7020	Standard	
	Medium	Max. C°
	Öl / Oil	160
	Wasser / Water	120

K7021	Hochtemperatur High temperature	
	Medium	Max. C°
	Öl / Oil	200
	Wasser / Water	160

K7022	Höchsttemperatur High of temperature	
	Medium	Max. C°
	Öl / Oil	300
	Wasser / Water	250

K7025 Sicherheitsschnellkupplung mit Schlauchtülle,
gerade Ausführung, mit Ventil oder freiem Durchgang



Wölfel-Industriebedarf
Industrievertretungen

Safety quick release coupling with hose nipple,
straight design, with and without valve

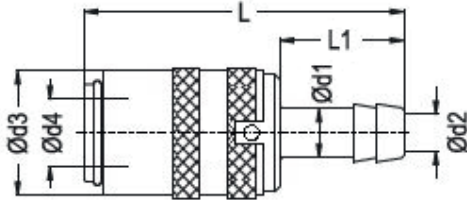

P= Stück / Normpackung // Pieces/ standard pack

Material: **Standardversion / Standard version**



Kupplungsgrundkörper: Messing / Coupler Body: Brass
Hülse: Messing / Sleeve: Brass
Ventil: Messing / Valve: Brass
Feder: Edelstahl / Spring: Stainless Steel
Sprengling: Edelstahl / Locking O-Ring: Stainless Steel
Kugeln: Edelstahl V-/ Balls: Stainless Steel

Betriebsdruck / Working pressure: p (bar)

Optionen / Options:

Verchromt / Chrome plated – Index: -Cr
Vernickelt / Nickel plated – Index: -Ni
Edelstahl / Stainless Steel – Index: -S

Bei optionaler Bestellung bitte Kennbuchstaben hinzufügen:
For optional orders please add the options index end of the order no.:
(Beispiel/example: K7025-d1-d4-V-Cr)

p (bar)	d2 (mm)	d3 (mm)	L (mm)	L1 (mm)	P	d1 (mm)	d4 (mm)	 Bestellnummer Order Number Mit Ventil / with Valve	 Bestellnummer Order Number ohne Ventil / without Valve
0 - 10	2,7	10	35	13,5	10	5	5	K7025-05-05-V	K7025-05-05
	4,5	17	46	17,0		6	9	K7025-06-09-V	K7025-06-09
	6					8		K7025-08-09-V	K7025-08-09
						9		K7025-09-09-V	K7025-09-09
						10		K7025-10-09-V	K7025-10-09
		52	23		13		K7025-13-09-V	K7025-13-09	
0 - 15	8	23	60			10	13	K7025-10-13-V	K7025-10-13
	10						13		K7025-13-13-V
0 - 20	13	31	90	32		19	19	K7025-19-19-V	K7025-19-19

Dauertemperatur / Long-term service temperature

K7025	Standard	
	Medium	Max. C°
	Öl / Oil	160
	Wasser / Water	120

K7026	Hochtemperatur High temperature	
	Medium	Max. C°
	Öl / Oil	200
	Wasser / Water	160

K7027	Höchsttemperatur High of temperature	
	Medium	Max. C°
	Öl / Oil	300
	Wasser / Water	250

K7030 Sicherheitsschnellkupplung mit Schlauchtülle,
45° Ausführung, mit Ventil oder freiem Durchgang

Safety quick release coupling with hose nipple,
45° design, with and without valve

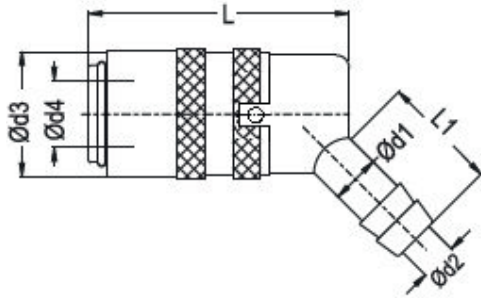

Material: **Standardversion / Standard version**

Kupplungsgrundkörper: Messing / Coupler Body: Brass
Hülse: Messing / Sleeve: Brass
Ventil: Messing / Valve: Brass
Feder: Edelstahl / Spring: Stainless Steel
Sprengling: Edelstahl / Locking O-Ring: Stainless Steel
Kugeln: Edelstahl V-/ Balls: Stainless Steel



Betriebsdruck / Working pressure: p (bar)

Optionen / Options:

Verchromt / Chrome plated – Index: -Cr
Vernickelt / Nickel plated – Index: -Ni
Edelstahl / Stainless Steel – Index: -S

P= Stück / Normpackung // Pieces/ standard pack

Bei optionaler Bestellung bitte Kennbuchstaben hinzufügen:
For optional orders please add the options index end of the order no.:
(Beispiel/example: K7030-d1-d4-V-Cr)

p	d2	d3	L	L1	P	d1	d4	 Bestellnummer Order Number Mit Ventil / with Valve	 Bestellnummer Order Number ohne Ventil / without Valve
0 - 10	2,7	10	29,5	13,5	10	5	5	K7030-05-05-V	K7030-05-05
	4,5	17	41	17,0		6	9	K7030-06-09-V	K7030-06-09
	6					8		K7030-08-09-V	K7030-08-09
						9		K7030-09-09-V	K7030-09-09
						10		K7030-13-09-V	K7030-13-09
0 - 15	8	23	51	23		10	13	K7030-10-13-V	K7030-10-13
	9					13		K7030-13-13-V	K7030-13-13
0 - 20	13	31	78	32		19	19	K7030-19-19-V	K7030-19-19

Dauertemperatur / Long-term service temperature

K7030	Standard	
	Medium	Max. C°
	Öl / Oil	160
	Wasser / Water	120

K7031	Hochtemperatur High temperature	
	Medium	Max. C°
	Öl / Oil	200
	Wasser / Water	160

K7032	Höchsttemperatur High of temperature	
	Medium	Max. C°
	Öl / Oil	300
	Wasser / Water	250

K7035 Sicherheitsschnellkupplung mit Schlauchtülle,
90° Ausführung, mit Ventil oder freiem Durchgang

Safety quick release coupling with hose nipple,
90° design, with and without valve

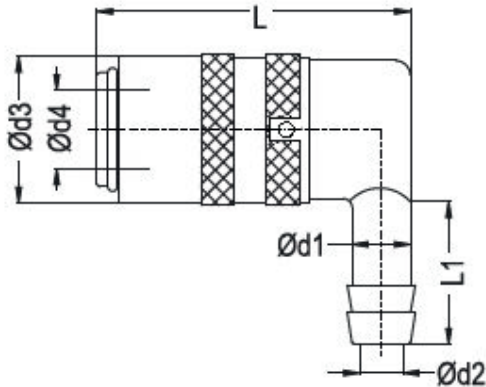

Material: **Standardversion / Standard version**

Kupplungsgrundkörper: Messing / Coupler Body: Brass
Hülse: Messing / Sleeve: Brass
Ventil: Messing / Valve: Brass
Feder: Edelstahl / Spring: Stainless Steel
Sprengring: Edelstahl / Locking O-Ring: Stainless Steel
Kugeln: Edelstahl V-/ Balls: Stainless Steel



Betriebsdruck / Working pressure: p (bar)

Optionen / Options:

Verchromt / Chrome plated – Index: -Cr
Vernickelt / Nickel plated – Index: -Ni
Edelstahl / Stainless Steel – Index: -S

P= Stück / Normpackung // Pieces/ standard pack

Bei optionaler Bestellung bitte Kennbuchstaben hinzufügen:
For optional orders please add the options index end of the order no.:
(Beispiel/example: K7035-d1-d4-V-Cr)

p (bar)	d2 (mm)	d3 (mm)	L (mm)	L1 (mm)	P	d1 (mm)	d4 (mm)	 Bestellnummer Order Number Mit Ventil / with Valve	 Bestellnummer Order Number ohne Ventil / without Valve
0 - 10	2,7	10	29,5	13,5	10	5	5	K7035-05-05-V	K7035-05-05
	4,5	17	41	17,0		6	9	K7035-06-09-V	K7035-06-09
	6					8		K7035-08-09-V	K7035-08-09
						9		K7035-09-09-V	K7035-09-09
						10		K7035-13-09-V	K7035-13-09
0 - 15	8	23	51	23		10	13	K7035-10-13-V	K7035-10-13
	9					13		K7035-13-13-V	K7035-13-13
0 - 20	13	31	78	32		19	19	K7035-19-19-V	K7035-19-19

Dauertemperatur / Long-term service temperature

K7035	Standard	
	Medium	Max. C°
	Öl / Oil	160
	Wasser / Water	120

K7036	Hochtemperatur High temperature	
	Medium	Max. C°
	Öl / Oil	200
	Wasser / Water	160

K7037	Höchsttemperatur High of temperature	
	Medium	Max. C°
	Öl / Oil	300
	Wasser / Water	250

K7040 Schnellkupplung mit Außengewinde,
gerade Ausführung, mit Ventil oder freiem Durchgang



Wölfel-Industriebedarf
Industrievertretungen

Quick release coupling with outside thread,
straight design, with and without valve

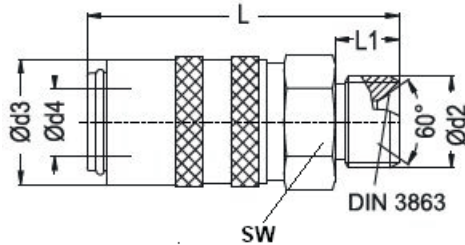

P= Stück / Normpackung // Pieces/ standard pack

Material: **Standardversion / Standard version**



Kupplungsgrundkörper: Messing / Coupler Body: Brass
Hülse: Messing / Sleeve: Brass
Ventil: Messing / Valve: Brass
Feder: Edelstahl / Spring: Stainless Steel
Sprengring: Edelstahl / Locking O-Ring: Stainless Steel
Kugeln: Edelstahl V-/ Balls: Stainless Steel

Betriebsdruck / Working pressure: p (bar)

Optionen / Options:

Verchromt / Chrome plated – Index: -Cr
Vernickelt / Nickel plated – Index: -Ni
Edelstahl / Stainless Steel – Index: -S

Bei optionaler Bestellung bitte Kennbuchstaben hinzufügen:
For optional orders please add the options index end of the order no.:
(Beispiel/example: K7040- d2-d4-V-Cr)

p (bar)	d3 (mm)	L (mm)	L1 (mm)	SW (mm)	P	d2	d4 (mm)	 Bestellnummer Order Number Mit Ventil / with Valve	 Bestellnummer Order Number ohne Ventil / without Valve
0 - 10	17	48	9	17	10	M10x1,0	9	K7040-10-09-V	K7040-10-09
						BSP 1/4"		K7040-1/4-09-V	K7040-1/4-09
						M14x1,5		K7040-14-09-V	K7040-14-09
						BSP 3/8"		K7040-3/8-09-V	K7040-3/8-09
0 - 15	23	52		21		M16x1,5	13	K7040-16-13-V	K7040-16-13
						BSP 3/8"		K7040-3/8-13-V	K7040-3/8-13
						BSP 1/2"		K7040-1/2-13-V	K7040-1/2-13
0 - 20	31	74	12	30		BSP 1/2"	19	K7040-1/2-19-V	K7040-1/2-19
						78		16	M24x1,5

Dauertemperatur / Long-term service temperature

K7040	Standard	
	Medium	Max. C°
	Öl / Oil	160
	Wasser / Water	120

K7041	Hochtemperatur High temperature	
	Medium	Max. C°
	Öl / Oil	200
	Wasser / Water	160

K7042	Höchsttemperatur High of temperature	
	Medium	Max. C°
	Öl / Oil	300
	Wasser / Water	250

K7045 Schnellkupplung mit Außengewinde,
45° Ausführung, mit Ventil oder freiem Durchgang

Quick release coupling with outside thread,
45° design, with and without valve

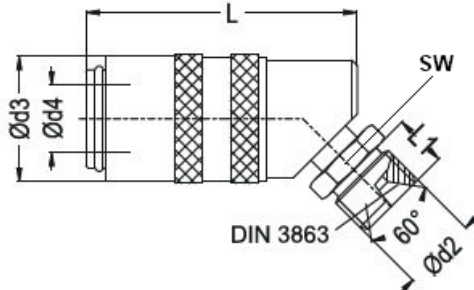

P= Stück / Normpackung // Pieces/ standard pack

Material: **Standardversion / Standard version**



Kupplungsgrundkörper: Messing / Coupler Body: Brass
Hülse: Messing / Sleeve: Brass
Ventil: Messing / Valve: Brass
Feder: Edelstahl / Spring: Stainless Steel
Sprengring: Edelstahl / Locking O-Ring: Stainless Steel
Kugeln: Edelstahl V-/ Balls: Stainless Steel

Betriebsdruck / Working pressure: p (bar)

Optionen / Options:

Verchromt / Chrome plated – Index: -Cr
Vernickelt / Nickel plated – Index: -Ni
Edelstahl / Stainless Steel – Index: -S

Bei optionaler Bestellung bitte Kennbuchstaben hinzufügen:
For optional orders please add the options index end of the order no.:
(Beispiel/example: K7045- d2-d4-V-Cr)

p (bar)	d3 (mm)	L (mm)	L1 (mm)	SW (mm)	P	d2 (mm)	d4 (mm)	 Bestellnummer Order Number Mit Ventil / with Valve	 Bestellnummer Order Number ohne Ventil / without Valve
0 - 10	17	48	9	17	10	BSP 1/4"	9	K7045-1/4-09-V	K7045-1/4-09
						M14x1,5		K7045-14-09-V	K7045-14-09
						BSP 3/8"		K7045-3/8-09-V	K7045-3/8-09
0 - 15	23	55	12	21		M16x1,5	13	K7045-16-13-V	K7045-16-13
						BSP 3/8"		K7045-3/8-13-V	K7045-3/8-13
						BSP 1/2"		K7045-1/2-13-V	K7045-1/2-13
0 - 20	31	76	14	30		BSP 1/2"	19	K7045-1/2-19-V	K7045-1/2-19
		78	16			M24x1,5		K7045-24-19-V	K7045-24-19

Dauertemperatur / Long-term service temperature

K7045	Standard	
	Medium	Max. C°
	Öl / Oil	160
	Wasser / Water	120

K7046	Hochtemperatur High temperature	
	Medium	Max. C°
	Öl / Oil	200
	Wasser / Water	160

K7047	Höchsttemperatur High of temperature	
	Medium	Max. C°
	Öl / Oil	300
	Wasser / Water	250

K7050 Schnellkupplung mit Außengewinde,
90° Ausführung, mit Ventil oder freiem Durchgang

Quick release coupling with outside thread,
90° design, with and without valve

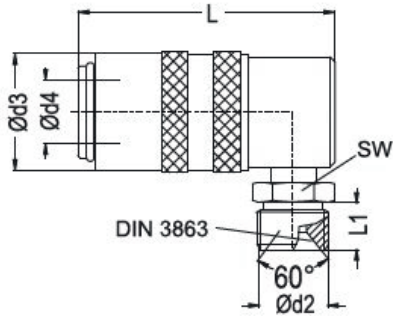

P= Stück / Normpackung // Pieces/ standard pack

Material: **Standardversion / Standard version**



Kupplungsgrundkörper: Messing / Coupler Body: Brass
Hülse: Messing / Sleeve: Brass
Ventil: Messing / Valve: Brass
Feder: Edelstahl / Spring: Stainless Steel
Sprengling: Edelstahl / Locking O-Ring: Stainless Steel
Kugeln: Edelstahl V-/ Balls: Stainless Steel

Betriebsdruck / Working pressure: p (bar)

Optionen / Options:

Verchromt / Chrome plated – Index: -Cr
Vernickelt / Nickel plated – Index: -Ni
Edelstahl / Stainless Steel – Index: -S

Bei optionaler Bestellung bitte Kennbuchstaben hinzufügen:
For optional orders please add the options index end of the order no.:
(Beispiel/example: K7050- d2-d4-V-Cr)

p	d3	L	L1	SW	P	d2	d4	 Bestellnummer Order Number Mit Ventil / with Valve	 Bestellnummer Order Number ohne Ventil / without Valve
0 - 10	17	48	11	17	10	BSP 1/4"	9	K7050-1/4-09-V	K7050-1/4-09
						M14x1,5		K7050-14-09-V	K7050-14-09
						BSP 3/8"		K7050-3/8-09-V	K7050-3/8-09
0 - 15	23	52	14	21	10	M16x1,5	13	K7050-16-13-V	K7050-16-13
						BSP 3/8"		K7050-3/8-13-V	K7050-3/8-13
						BSP 1/2"		K7050-1/2-13-V	K7050-1/2-13
0 - 20	31	76	14	30	10	BSP 1/2"	19	K7050-1/2-19-V	K7050-1/2-19
		78	16			M24x1,5		K7050-24-19-V	K7050-24-19

Dauertemperatur / Long-term service temperature

K7050	Standard	
	Medium	Max. C°
	Öl / Oil	160
	Wasser / Water	120

K7051	Hochtemperatur High temperature	
	Medium	Max. C°
	Öl / Oil	200
	Wasser / Water	160

K7052	Höchsttemperatur High of temperature	
	Medium	Max. C°
	Öl / Oil	300
	Wasser / Water	250

K7055 Schnellkupplung mit Außengewinde,
 kuze Ausführung, mit Ventil

Quick release coupling with outside thread,
 short design, with valve

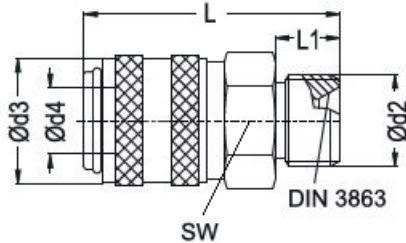

P= Stück / Normpackung // Pieces/ standard pack

Material: **Standardversion / Standard version**



Kupplungsgrundkörper: Messing / Coupler Body: Brass
 Hülse: Messing / Sleeve: Brass
 Ventil: Messing / Valve: Brass
 Feder: Edelstahl / Spring: Stainless Steel
 Sprengring: Edelstahl / Locking O-Ring: Stainless Steel
 Kugeln: Edelstahl V-/ Balls: Stainless Steel

Betriebsdruck / Working pressure: p (bar)

Optionen / Options:

Verchromt / Chrome plated – Index: -Cr
 Vernickelt / Nickel plated – Index: -Ni
 Edelstahl / Stainless Steel – Index: -S

Bei optionaler Bestellung bitte Kennbuchstaben hinzufügen:
 For optional orders please add the options index end of the order no.:
 (Beispiel/example: K7055- d2-d4-V-Cr)

p (bar)	d3 (mm)	L (mm)	L1 (mm)	SW (mm)	P	d2 (mm)	d4 (mm)	 Bestellnummer Order Number Mit Ventil / with Valve	 Bestellnummer Order Number ohne Ventil / without Valve
0 - 10	18	38	9	17	10	BSP 1/4"	9	K7055-10-09-V	K7055-10-09
0 - 15	23			21		BSP 3/4"	13	K7055-1/4-09-V	K7055-1/4-09

Dauertemperatur / Long-term service temperature

K7055	Standard	
	Medium	Max. C°
	Öl / Oil	160
	Wasser / Water	120

K7056	Hochtemperatur High temperature	
	Medium	Max. C°
	Öl / Oil	200
	Wasser / Water	160

K7057	Höchsttemperatur High of temperature	
	Medium	Max. C°
	Öl / Oil	300
	Wasser / Water	250

K7060 Sicherheitsschnellkupplung mit Außengewinde,
gerade Ausführung, mit Ventil oder freiem Durchgang



Wölfel-Industriebedarf
Industrievertretungen

Safety quick release coupling with outside thread,
straight design, with and without valve

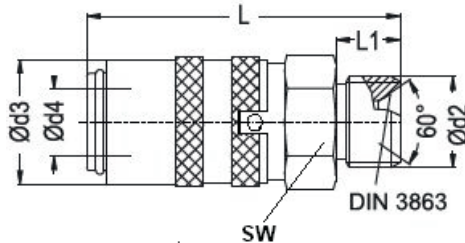

P= Stück / Normpackung // Pieces/ standard pack

Material: **Standardversion / Standard version**



Kupplungsgrundkörper: Messing / Coupler Body: Brass
Hülse: Messing / Sleeve: Brass
Ventil: Messing / Valve: Brass
Feder: Edelstahl / Spring: Stainless Steel
Sprengling: Edelstahl / Locking O-Ring: Stainless Steel
Kugeln: Edelstahl V-/ Balls: Stainless Steel

Betriebsdruck / Working pressure: p (bar)

Optionen / Options:

Verchromt / Chrome plated – Index: -Cr
Vernickelt / Nickel plated – Index: -Ni
Edelstahl / Stainless Steel – Index: -S

Bei optionaler Bestellung bitte Kennbuchstaben hinzufügen:
For optional orders please add the options index end of the order no.:
(Beispiel/example: K7060- d2-d4-V-Cr)

p (bar)	d3 (mm)	L (mm)	L1 (mm)	SW (mm)	P	d2	d4 (mm)	 Bestellnummer Order Number Mit Ventil / with Valve	 Bestellnummer Order Number ohne Ventil / without Valve
0 - 10	17	48	9	17	10	M10x1,0	9	K7060-10-09-V	K7060-10-09
						BSP 1/4"		K7060-1/4-09-V	K7060-1/4-09
						M14x1,5		K7060-14-09-V	K7060-14-09
						BSP 3/8"		K7060-3/8-09-V	K7060-3/8-09
0 - 15	23	52		21		M16x1,5	13	K7060-16-13-V	K7060-16-13
						BSP 3/8"		K7060-3/8-13-V	K7060-3/8-13
						BSP 1/2"		K7060-1/2-13-V	K7060-1/2-13
0 - 20	31	74	12	30		BSP 1/2"	19	K7060-1/2-19-V	K7060-1/2-19
		78	16			M24x1,5		K7060-24-19-V	K7060-24-19

Dauertemperatur / Long-term service temperature

K7060	Standard	
	Medium	Max. C°
	Öl / Oil	160
	Wasser / Water	120

K7061	Hochtemperatur High temperature	
	Medium	Max. C°
	Öl / Oil	200
	Wasser / Water	160

K7062	Höchsttemperatur High of temperature	
	Medium	Max. C°
	Öl / Oil	300
	Wasser / Water	250

K7065 Schnellkupplung mit Innengewinde,
mit Ventil oder freiem Durchgang

Quick release coupling with inside thread,
with and without valve

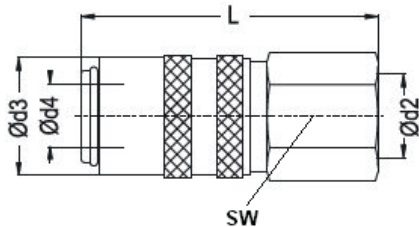

P= Stück / Normpackung // Pieces/ standard pack

Bei optionaler Bestellung bitte Kennbuchstaben hinzufügen:
For optional orders please add the options index end of the order no.:
(Beispiel/example: K7065- d2-d4-V-Cr)



Material: **Standardversion / Standard version**

Kupplungsgrundkörper: Messing / Coupler Body: Brass
Hülse: Messing / Sleeve: Brass
Ventil: Messing / Valve: Brass
Feder: Edelstahl / Spring: Stainless Steel
Sprengling: Edelstahl / Locking O-Ring: Stainless Steel
Kugeln: Edelstahl V-/ Balls: Stainless Steel

Betriebsdruck / Working pressure: p (bar)

Optionen / Options:

Verchromt / Chrome plated – Index: -Cr
Vernickelt / Nickel plated – Index: -Ni
Edelstahl / Stainless Steel – Index: -S

p	d3	L	L1	SW	P	d2	d4	 Bestellnummer Order Number Mit Ventil / with Valve	 Bestellnummer Order Number ohne Ventil / without Valve
0 - 10	17	44	9	17	10	M10x1,0	9	K7065-10-09-V	K7065-10-09
			11			BSP 1/4"		K7065-1/4-09-V	K7065-1/4-09
						M14x1,5		K7065-14-09-V	K7065-14-09
						BSP 3/8"		K7065-3/8-09-V	K7065-3/8-09
0 - 15	23	48		21		M16x1,5	13	K7065-16-13-V	K7065-16-13
						BSP 3/8"		K7065-3/8-13-V	K7065-3/8-13
						BSP 1/2"		K7065-1/2-13-V	K7065-1/2-13
0 - 20	31	70	14	30		BSP 1/2"	19	K7065-1/2-19-V	K7065-1/2-19
		72	16			M24x1,5		K7065-24-19-V	K7065-24-19
						BSP 3/4"		K7065-3/4-19-V	K7065-3/4-19

Dauertemperatur / Long-term service temperature

K7065	Standard	
	Medium	Max. C°
	Öl / Oil	160
	Wasser / Water	120

K7066	Hochtemperatur	
	High temperature	
	Medium	Max. C°
	Öl / Oil	200
	Wasser / Water	160

K7067	Höchsttemperatur	
	High of temperature	
	Medium	Max. C°
	Öl / Oil	300
	Wasser / Water	250

K7070 Schnellkupplung mit Nippel,
gerade Ausführung, mit Ventil oder freiem Durchgang



Wölfel-Industriebedarf
Industrievertretungen

Quick release coupling with plug,
straight design, with and without valve

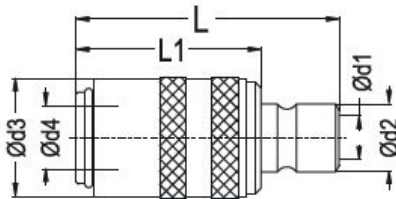

P= Stück / Normpackung // Pieces/ standard pack

Material: **Standardversion / Standard version**



Kupplungsgrundkörper: Messing / Coupler Body: Brass
Hülse: Messing / Sleeve: Brass
Ventil: Messing / Valve: Brass
Feder: Edelstahl / Spring: Stainless Steel
Sprengling: Edelstahl / Locking O-Ring: Stainless Steel
Kugeln: Edelstahl V-/ Balls: Stainless Steel

Betriebsdruck / Working pressure: p (bar)

Optionen / Options:

Verchromt / Chrome plated – Index: -Cr
Vernickelt / Nickel plated – Index: -Ni
Edelstahl / Stainless Steel – Index: -S

Bei optionaler Bestellung bitte Kennbuchstaben hinzufügen:
For optional orders please add the options index end of the order no.:
(Beispiel/example: K7070-d1-d4-V-Cr)

p (bar)	d2 (mm)	d3 (mm)	L (mm)	L1 (mm)	P	d1 (mm)	d4 (mm)	 Bestellnummer Order Number Mit Ventil / with Valve	 Bestellnummer Order Number ohne Ventil / without Valve
0 - 10	9	18	56	44	10	6	9	K7070-06-09-V	K7070-06-09
0 - 15		23	57,5	45			13	K7070-06-13-V	K7070-06-13
0 - 10	13	18	58,5	44		9	9	K7070-09-09-V	K7070-09-09
0 - 15		23	60	45			13	K7070-09-13-V	K7070-09-13

Dauertemperatur / Long-term service temperature

K7070	Standard	
	Medium	Max. C°
	Öl / Oil	160
	Wasser / Water	120

K7071	Hochtemperatur High temperature	
	Medium	Max. C°
	Öl / Oil	200
	Wasser / Water	160

K7072	Höchsttemperatur High of temperature	
	Medium	Max. C°
	Öl / Oil	300
	Wasser / Water	250

K7075 Blindkupplung,

Dummy coupling

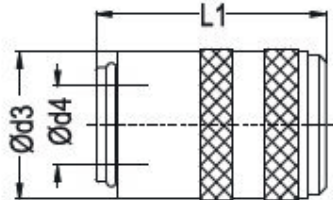

P= Stück / Normpackung // Pieces/ standard pack

Material: **Standardversion / Standard version**

Kupplungsgrundkörper: Messing / Coupler Body: Brass
 Hülse: Messing / Sleeve: Brass
 Ventil: Messing / Valve: Brass
 Feder: Edelstahl / Spring: Stainless Steel
 Sprengring: Edelstahl / Locking O-Ring: Stainless Steel
 Kugeln: Edelstahl V-/ Balls: Stainless Steel

Betriebsdruck / Working pressure: p (bar)

Optionen / Options:

Verchromt / Chrome plated – Index: -Cr
 Vernickelt / Nickel plated – Index: -Ni
 Edelstahl / Stainless Steel – Index: -S

Bei optionaler Bestellung bitte Kennbuchstaben hinzufügen:
 For optional orders please add the options index end of the order no.:
 (Beispiel/example: K7075-d4-Cr)

p (bar)	d3 (mm)	L1 (mm)	P	d4 (mm)	Bestellnummer Order Number
0 - 10	18	34	10	9	K7075-09
0 - 15	23	40		13	K7075-13

Dauertemperatur / Long-term service temperature

K7075	Standard	
	Medium	Max. C°
	Öl / Oil	160
	Wasser / Water	120

K7076	Hochtemperatur High temperature	
	Medium	Max. C°
	Öl / Oil	200
	Wasser / Water	160

K7077	Höchsttemperatur High of temperature	
	Medium	Max. C°
	Öl / Oil	300
	Wasser / Water	250

K7080 Umlenkkupplung,
mit Ventil oder freiem Durchgang

Diverting coupling unit,
with and without valve

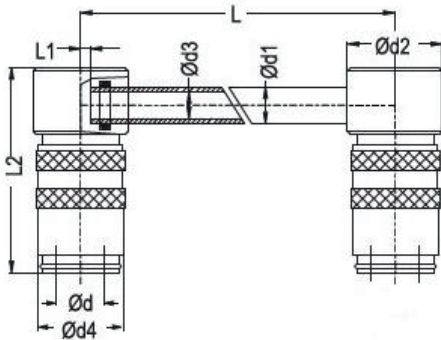

P= Stück / Normpackung // Pieces/ standard pack

Bei optionaler Bestellung bitte Kennbuchstaben hinzufügen:
For optional orders please add the options index end of the order no.:
(Beispiel/example: K7080-d-L-V-Cr)



Material: **Standardversion / Standard version**

Kupplungsgrundkörper: Messing / Coupler Body: Brass
Hülse: Messing / Sleeve: Brass
Ventil: Messing / Valve: Brass
Feder: Edelstahl / Spring: Stainless Steel
Sprengring: Edelstahl / Locking O-Ring: Stainless Steel
Kugeln: Edelstahl V-/ Balls: Stainless Steel

Betriebsdruck / Working pressure: p (bar)

Optionen / Options:

Verchromt / Chrome plated – Index: -Cr
Vernickelt / Nickel plated – Index: -Ni
Edelstahl / Stainless Steel – Index: -S

p	d1	d2	d3	d4	L1	L2	P	d	L	 Bestellnummer Order Number Mit Ventil / with Valve	 Bestellnummer Order Number ohne Ventil / without Valve
0-10	8	20	6	17	0	44	2	9	125	K7080-09-125-V	K7080-09-125
									250	K7080-09-250-V	K7080-09-250
									500	K7080-09-500-V	K7080-09-500
0-15	10	26	8	23	2	53		13	125	K7080-13-125-V	K7080-13-125
									250	K7080-13-250-V	K7080-13-250
									500	K7080-13-500-V	K7080-13-500
0-20	14	36	12	31	3	80		19	160	K7080-19-160-V	K7080-19-160
									315	K7080-19-315-V	K7080-19-315
									500	K7080-19-500-V	K7080-19-500

Dauertemperatur / Long-term service temperature

K7080	Standard	
	Medium	Max. C°
	Öl / Oil	160
	Wasser / Water	120

K7081	Hochtemperatur High temperature	
	Medium	Max. C°
	Öl / Oil	200
	Wasser / Water	160

K7082	Höchsttemperatur High of temperature	
	Medium	Max. C°
	Öl / Oil	300
	Wasser / Water	250

K7085 Adapterkupplung,

Adapter coupling

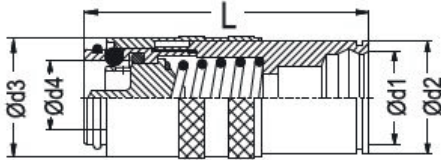

P= Stück / Normpackung // Pieces/ standard pack

Bei optionaler Bestellung bitte Kennbuchstaben hinzufügen:
For optional orders please add the options index end of the order no.:
(Beispiel/example: K7080-d4-V-Cr)



Material: **Standardversion / Standard version**

Kupplungsgrundkörper: Messing / Coupler Body: Brass
Hülse: Messing / Sleeve: Brass
Ventil: Messing / Valve: Brass
Feder: Edelstahl / Spring: Stainless Steel
Sprengring: Edelstahl / Locking O-Ring: Stainless Steel
Kugeln: Edelstahl V-/ Balls: Stainless Steel

Betriebsdruck / Working pressure: p (bar)

Optionen / Options:

Verchromt / Chrome plated – Index: -Cr
Vernickelt / Nickel plated – Index: -Ni
Edelstahl / Stainless Steel – Index: -S

d3 (mm)	d2 (mm)	d1 (mm)	L (mm)	P	d4 (mm)	 Bestellnummer Order Number Mit Ventil / with Valve	 Bestellnummer Order Number ohne Ventil / without Valve
18	21	17	56	5	9	K7085-09-V	K7085-09
23			60		13	K7085-13-V	K7085-13

Dauertemperatur / Long-term service temperature

K7085	Standard	
	Medium	Max. C°
	Öl / Oil	160
	Wasser / Water	120

K7086	Hochtemperatur High temperature	
	Medium	Max. C°
	Öl / Oil	200
	Wasser / Water	160

K7087	Höchsttemperatur High of temperature	
	Medium	Max. C°
	Öl / Oil	300
	Wasser / Water	250